

OPTIMAL LIGHT *Professional*

LED SLIM PANEL LIGHT



LED Lighting Professionals

LED ULTRA SLIM PANEL LIGHT

OPTIMAL LIGHT'S ULTRA SLIM PANEL LIGHTS ARE SO UNIQUE IN SPECIFICATION AND DESIGN. PMMA LGP, IP 40 PROTECTION AVIATION ALUMINUM BODY. 100 -277 VOLTAGE 50,000 HOURS LIFE TIME.

36 -40 - 72 - Watt



SIZES: 600 X 600 600 X 1200 300 X 1200 MM

- CB
- CE
- SASO
- FLICKER FREE
- 50,000 Hrs.
- FIVE YEARS
- 120°
- 110-120 LUMEN/W
- PF >0.9
- UGR <19
- IP 40
- VOLT. 100-277
- VOLT. 220-240

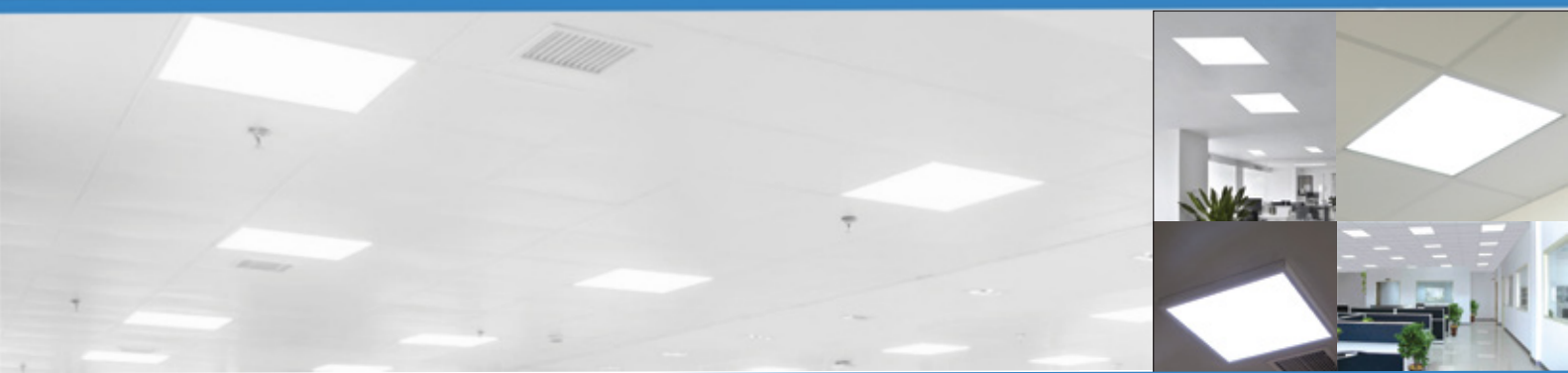



► Advantages:

- 2 Sides Edge-lit, less heat dissipation, longer lifespan
- 100% PMMA LGP, never yellowing
- Patent design to avoid blue light & water ripper & light spot
- double side welding Alu-frame and seamless, high-end appearance and stronger structure, no easy cracked during the long transportation, no light leakage
- concave-convex edge fold back plate, unique and elegant to stand out in the market, stronger structure, no mosquitoes coming in
- Flicker free
- UGR<19 available
- Lifetime 50,000 hrs
- Optional: On/Off, DALI, Triac-dim, Push-dim, 0/1-10V Dim
- Warranty 5 years

► Application:

- Office
- Schools
- Supermarkets
- Store
- Museums
- Meeting room
- Hospitals
- Hotels
- Home lighting
- All indoor lighting and commercial lighting



► Technical Characteristics:

Brand	OPTIMAL LIGHT			
Version	6060	6060	3012	6012
Model No.	OPT-6060-40S	OPT-6060-36S	OPT-3012-40N	OPT-6012-72S
Power	40W	36W	40W	72W
Lumen Flux	4000LM	3600LM	4000LM	7200LM
LED chip	High Quality SMD4041			
CCT	3000K/4000K/6500K			
CRI	>80			
Lumen Efficacy	100LM/W			
Input Voltage	AC220-240V	AC100-277V	AC 220-240V	AC100-277V
Electrical Protection	Class II			
Beam Angle	110°/ 90°			
SPD	1KV			
Driver	Eaglerise	Optimal	Eaglerise	Optimal
PF	>0.9			
THD	<20%			
IP Rating	IP40			
Lifetime	50,000hrs			
Warranty	5 years			

► Light Distribution Curve:

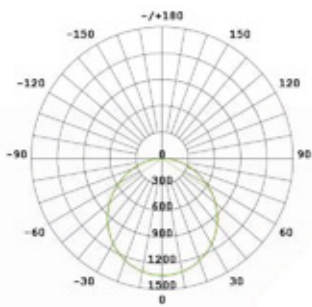

OPT-6060-36S

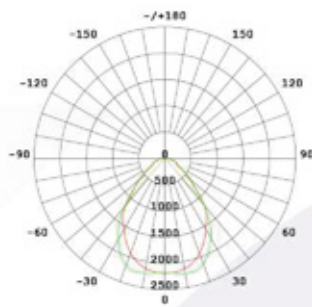

OPT-6060-40S

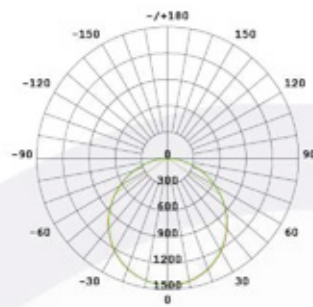

OPT-3012-40N

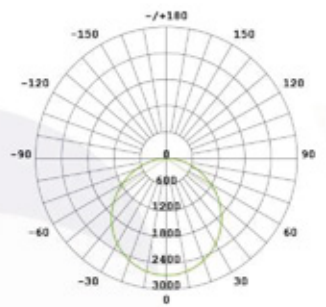

OPT-6012-72S

► Installation:

Recession Installation

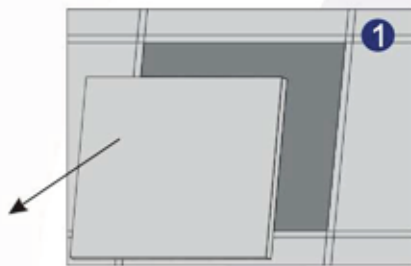

1. Remove the plasterboard from the ceiling.

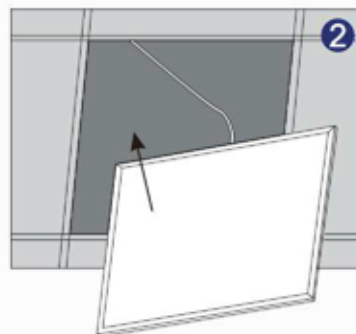

2. Fix the panel into ceiling

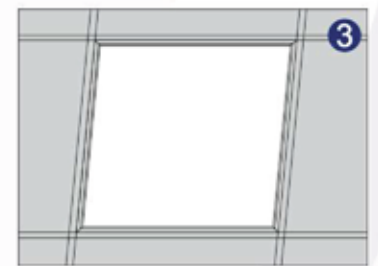

3. Installation finished

Recessed Frame MG-M002

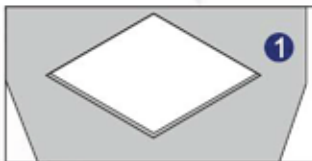

1. Open a hole on the ceiling.



2. Fix the frame to the hole.

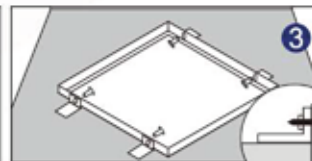

3. Fix the frame to the ceiling with the screws and "L" accessory.

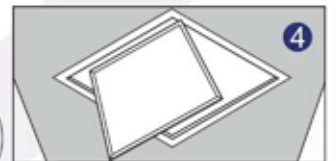

4. Put the panel into the frame.

Suspension Installation MG-D001

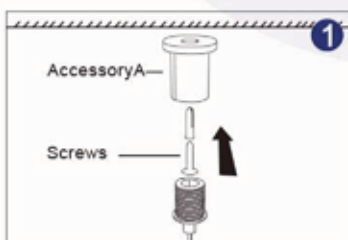

1. Screwing accessories A in ceiling.

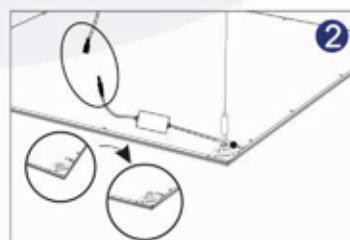

2. Upward hook on 4 corners, for suspending.

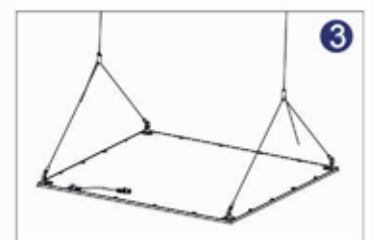

3. Finished installation.

Suspension Installation MG-D001



1. Assemble the 3 pieces of frame by metal bracket.

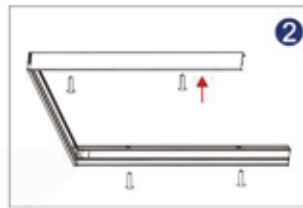

2. Fix the square frames in to ceiling with Screw.

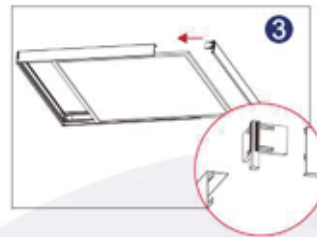

3. Insert the panel into frames and fix the cover plate frame.



4. Finished frame installation.

Spring Installation MG-P01

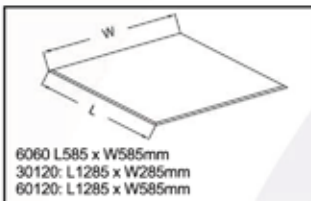

1. Open a hole on the ceiling with the size noted on the drawing.

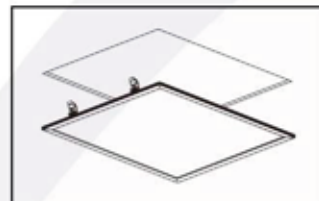

2. Pull up the springs.



3. Install the panel to the hole.

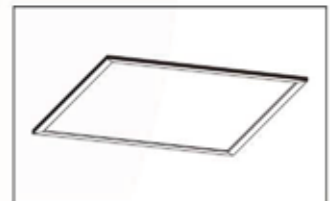

4. Fix the panel to the ceiling.

► Size And Packing:

Item	Product size(mm)	Packing size(mm)	N.W.(kg)	G.W.(kg)
OPT-6060-36S	595*595*10mm	655x200x705mm	2.4	2.8
OPT-6060-40S	595*595*10mm	655x200x705mm	2.4	2.8
OPT-3012-40N	295*1195*10mm	1255x200x405mm	2.4	3
OPT-6012-72S	595*1195*10mm	1255x140x705mm	4.6	5.8

► Materials:

Product Colour/Powder Coating RAL no: RAL9016	LGP material: PMMA
Frame: Aluminum	Diffuser material: PS

► Product Dimension:

